



LEEMIN  
黎明液压

## QFZ系列蓄能器控制阀

### QFZ COMBINATION VALVES FOR ACCUMULATOR CONTROL

#### (一) 简介 INTRODUCTION

QFZ系列蓄能器控制阀组由球式截止阀、直动式溢流阀及针形截止阀组成。球形截止阀为手动主开关阀,使蓄能器与液压系统间接通或断开;直动式溢流阀为安全阀;针形截止阀是卸压阀,作用是当球形截止阀关闭时,打开针形阀,使蓄能器卸压放油。本系列蓄能器控制阀组主油口采用焊接式连接法兰。

The combination valve for accumulator control is made up of high-pressure ball stop valve, direct-control overflow valve and a small stop valve. The high-pressure ball stop valve serves as a manual-operated main switch valve, the direct-control overflow valve as a safety valve and the small stop valve as a load relief valve. It is a valve combination indispensable to the circuit of accumulator in a hydraulic system. Another characteristic of QFZ combination valve for accumulator control is that connection is achieved through direct welding of flange, which may significantly lower the installation position of accumulators.

#### (二) 型号说明 MODEL CODE

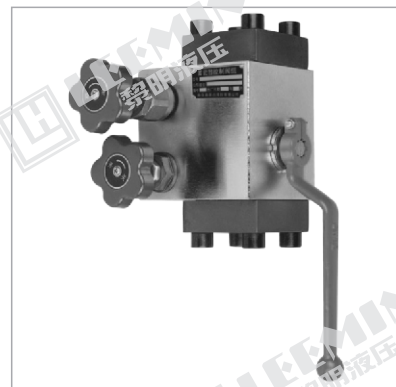

- 1.使用时必须把针形截止阀拧紧。
- 2.若公称口径25mm,安全阀的调压范围16-31.5MPa,则蓄能器控制阀型号为QFZ-Hd25F。
- 1.Tightening the needle stop valve when the safety ball valve is put into use.
2. The nominal diameter: 25mm, the pressure adjusting range from 16 to 31.5MPa the model of this combination valves for accumulator is QFZ-Hd25F

#### (三) 连接尺寸 MOUNTING SIZE

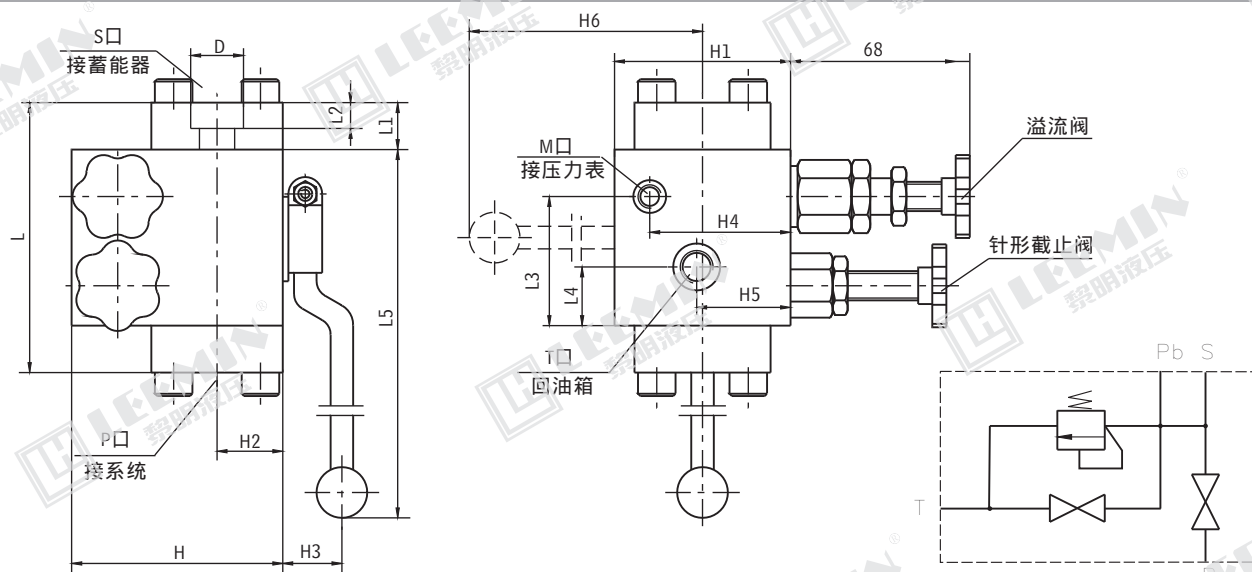

型号 Model	L	L1	L2	L3	L4	L5	H	H1	H2	H3	H4	H5	H6	D	T	M	重量(kg)
QFZ-H*15F	115	20	11	55	25	169	90	75	28	36	60	40	129	22.5	M14X1.5	M10X1	5
QFZ-H*25F	155	25	14	75	30	240	110	90	36	52	65	45	175	35	M18X1.5		9
QFZ-H*40F	180	30	15	90	35	283	140	100	48	60	65	45	210	52	M18X1.5	M14X1.5	19
QFZ-H*50F	230	35	15	115	56	322	160	120	60	66	70	45	217	64	M22X1.5		27