



**CWU系列磁性过滤器**  
**CWU MAGNETIC FILTER SERIES**

CWU-10X100B 磁性过滤器用于精密车床中润滑液的过滤，产品外壳为有机玻璃，为滤除加工中产生的超细铁屑粉末，滤芯中装了永久磁铁。

CWU-A25X60 磁性过滤器用于精密机床中主轴箱等润滑油的过滤，滤芯中装有永久磁铁，滤材为不锈钢丝网，便于清洗。

There are two models in this series. CWU-10X100B magnetic filter is used in the lubricating system of precision lathe. Filter element is made of stainless steel wire Mesh which can keep the system clean.

CWU-A25X60 filter is used in the head box of precision lathe. There is a permanent magnet in the core of element the filter, media is made of stainless steel wire mesh.



| 型号<br>Model | 压力Pressure<br>(MPa) | 流量Flow<br>(L/min) | 过滤精度Filtr.<br>( $\mu$ m) | 温度<br>Temp.             |
|-------------|---------------------|-------------------|--------------------------|-------------------------|
| CWU-10X100B | 0.5                 | 10                | 100                      | 50 $\pm$ 5 $^{\circ}$ C |
| CWU-A25X60  | 1.6                 | 25                | 60                       |                         |

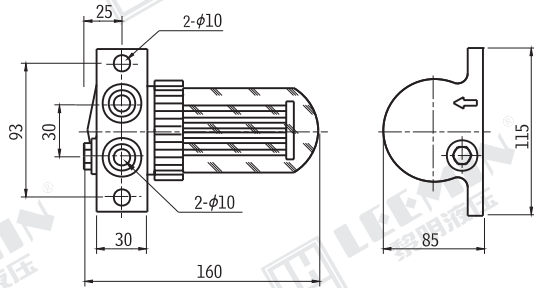

CWU-10X100B

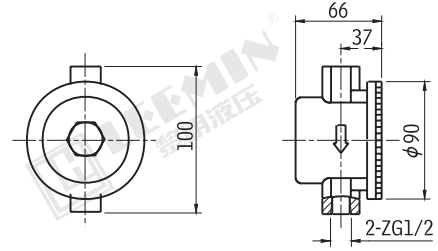

CWU-A25X60